



Phone 937-223-4ART(4278)

www.daytonartinstitute.org

Like us on Facebook!
facebook.com/daytonartinstitute

NURSING ROOM

RESTROOMS FAMILY RESTROOM

WHEELCHAIR ACCESS ELEVATOR

MUSEUM HOURS

OPEN
Wednesday, Friday, and Saturday
11:00 a.m. to 5:00 p.m.
Thursday, 11:00 a.m. to 8:00 p.m.
Sunday, noon to 5:00 p.m.

CLOSED
Mondays, Tuesdays,
& major holidays

- 101 Bonbright Gallery of African Art
- 102 The Harold W. and Mary Louise Shaw Foundation Gallery for Art of the Ancient Americas
- 103 Buddhist Art
- 104 Southeast Asian Art
- 105-107 Japanese Art
- 108 Korean Art
- 109 Asian Art
- 110-113 Chinese Art
- 114 Tibetan Art
- 115 Indian Art
- 117 Virginia W. Kettering Gallery
- 118 James M. Cox Gallery
- 119-122 Special Exhibitions Gallery
- 123 Eileen Dicke Gallery of Glass
- 124 The Lange Family Experiencenter
- 125-126 South Gallery
- 127-128 North Gallery

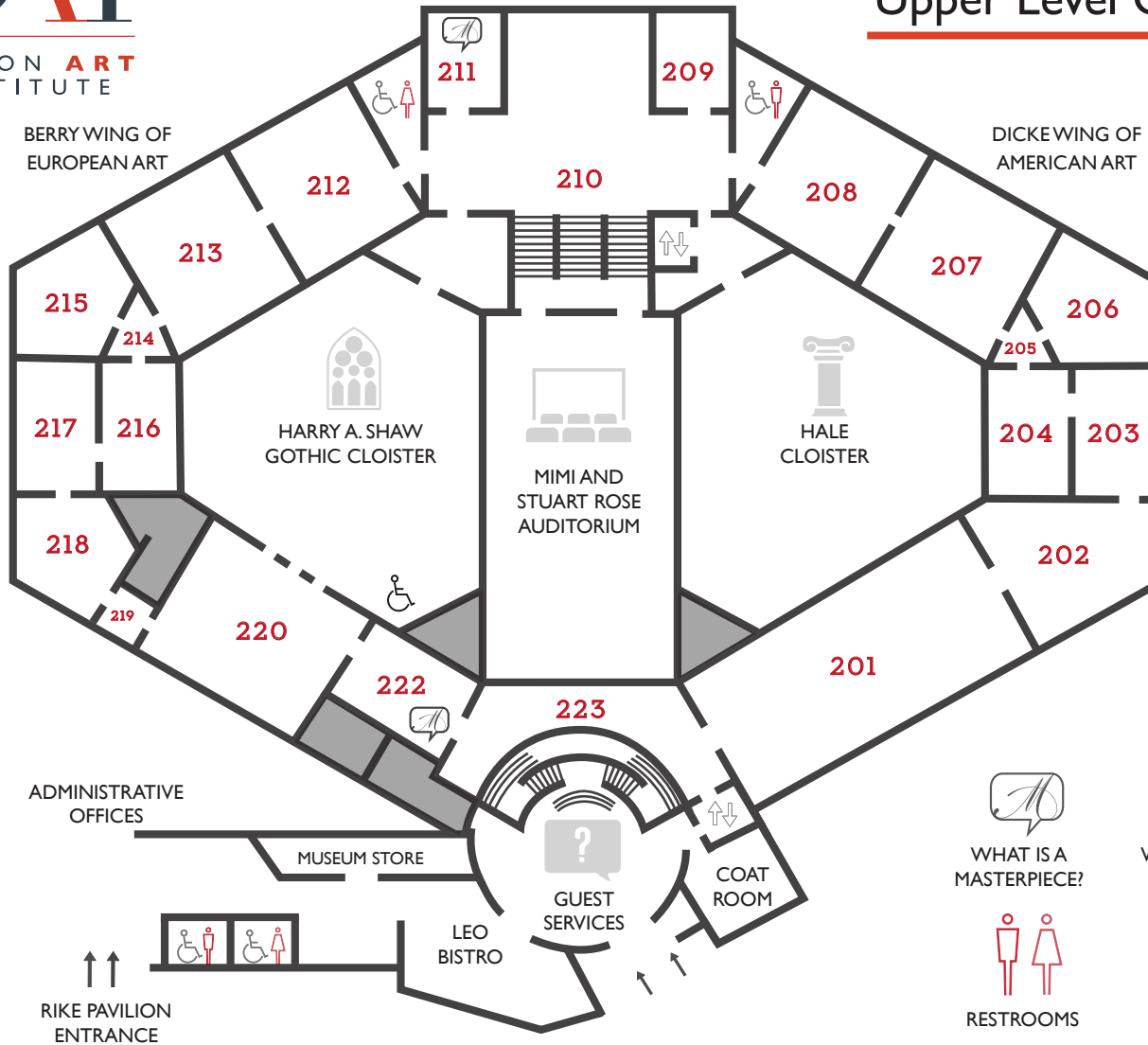

- 201 James F. Dicke Gallery of Contemporary Art
- 202 Katy Dicke Gallery of Post 1945 American Art
- 203 Janet S. Dicke Gallery of Early 20th Century American Modernism
- 204 J. Bradford Tillson Gallery of Early 20th Century American Modernism
- 205 American Decorative Arts
- 206 Jennifer St. Clair Dicke Gallery of Early 20th Century American Art
- 207 Dayton Power and Light Company Gallery of 19th Century American Art
- 208 Warren and Mary Webster Gallery of Colonial and Early American Art
- 209 Native American Gallery
- 210 Great Hall/Sculpture Court
- 211 Ancient Art Gallery
- 212 Bieser Family Gallery of Late 19th Century French Art
- 213 Gray Gallery of 18th Century European Art
- 214 European Decorative Arts
- 215 17th Century Baroque Art in Flanders and France
- 216 The Epstein Family Gallery of 17th Century Dutch Art
- 217 17th Century Baroque Painting in Italy
- 218 Kresge Foundation Gallery of 16th and 17th Century European Art
- 219 16th and 17th Century European Art
- 220 Late Medieval and Renaissance Art
- 222 Carl H. and Irene K. Dicke Gallery
- 223 Entrance Rotunda

 WHAT IS A MASTERPIECE?
 WHEELCHAIR ACCESS
 RESTROOMS
 ELEVATOR

 **PHOTOGRAPHY**

Non-commercial photography of the museum's permanent collection is permitted inside and outside. No flashes, tripods or video cameras are allowed inside the museum. Photography is not permitted in special exhibitions unless otherwise stated within the galleries. Requests for staged portraits or commercial photography inside the museum must be made in advance by calling 937-512-0162 (\$75 fee applies).